

Qty: 3 Ref: 2702 Start of temporary diversion route	<div>Diversion →</div>
Qty: 2 Ref: 2702 End of temporary diversion route	<div>Diversion ENDS</div>
Qty: 3 Ref: 2703 Direction of temporary diversion route from junction ahead	<div>Diverted traffic →</div>
Qty: 2 Ref: 2703 Direction of temporary diversion route from junction ahead	<div>← Diverted traffic</div>
Qty: 2 Ref: 7010-FP-13-9 Nature of temporary hazard ahead - Road Ahead Closed	<div>ROAD AHEAD CLOSED</div>
Qty: 2 Ref: 7010-FP-13-9 Nature of temporary hazard ahead - Road Closed	<div>ROAD CLOSED</div>

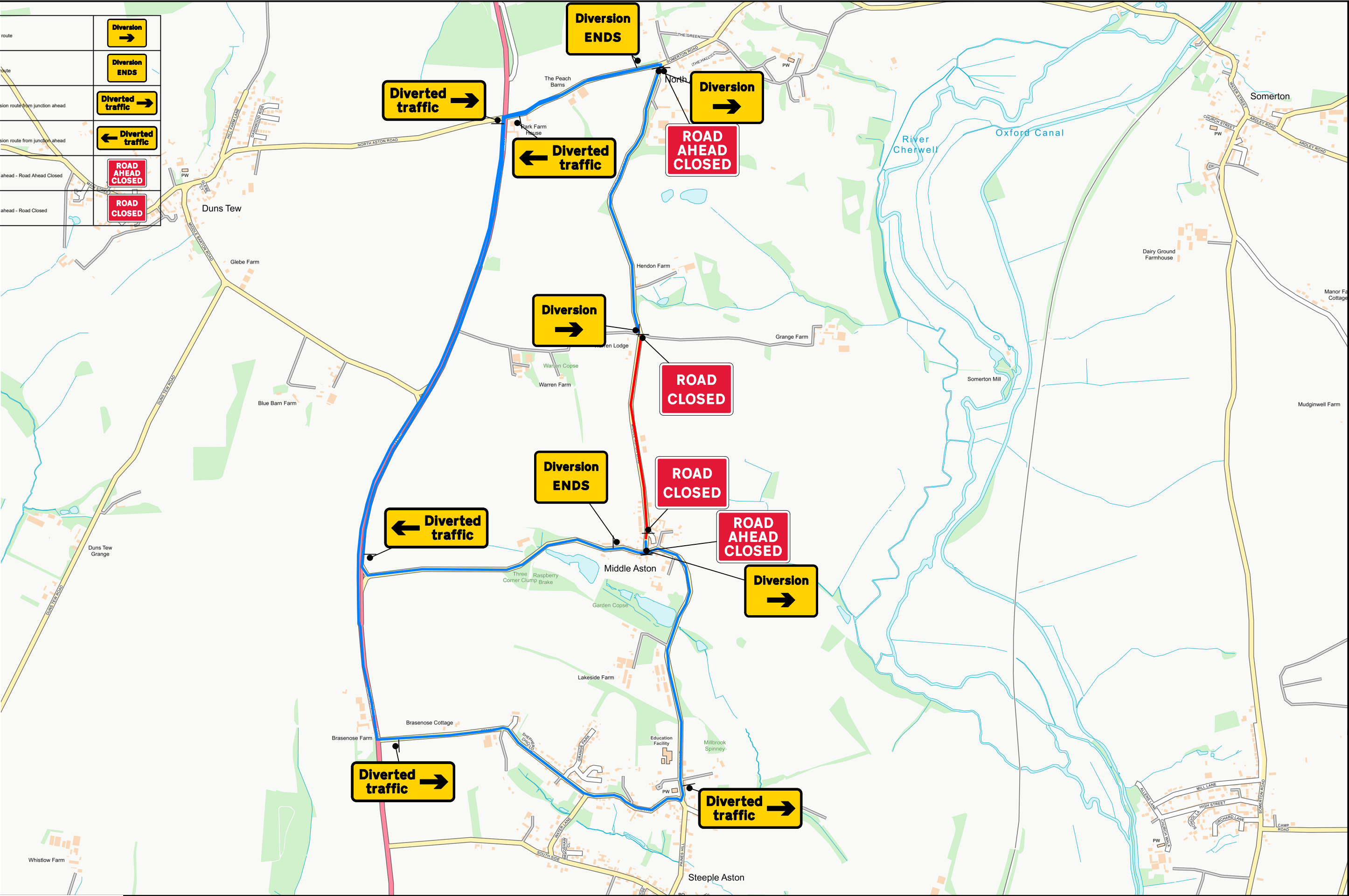

ROAD CLOSURE  
TRAFFIC MANAGEMENT LAYOUT  
SUBJECT TO CHANGE

1	TBC
Issue	Date

Middle Aston Lane  
Middle Aston  
OX25 5PX

Billy Wardle - 07711284942

Traffic Management Manager

Original drawing size A3 - NTS